

ANNEX-A					
 CONSTRUCTION OF ANIMAL SHED AT KILLI HAJI KAMAL TAHLO UC GARRANG WASHUK					
ESTIMATE OF ANIMAL SHED					
Sr #	Description	Quantity	Unit	Unit Rate	Total Amount
1	Excavation in foundation of buildings and bridges including layout, dressing, refilling around structures with excavated earth, watering & ramming lead upto 100 ft. (30m) & lift upto 5 ft. (1.5m)	752	Cft		
2	Unburnt Brick Providing and laying sundried clay bricks set in mud mortar including scaffolding in fonudation and substructure.	2328.25	Cft		
3	Providing and filling earth over roof including watering, ramming, mud plastering with gobi leaping 3 inches (75mm) thick earth filling and mud plastering 1 inch (25mm) nominal thickness.	804	Sft		
4	Mud Plaster	3076	Sft		
5	Girder	46	Rft		
6	Bamboo (20 ft. (6 m.) long and 3.5" to 4" (87.5 mm to 100 mm) dia.	610.0	Rft		
7	Mat (Thakird)	804	Sft		
8	Mat (Partal)	804	Sft		
9	Roof Plastic (Double Play)	804	Sft		
10	Providing and installation of Iron Gate size(4'x 5') for animal shed using angle iron (3'x3'x 1/4") for frame , ILL-M pipe 1/2" dia use for center portion) as directed by Engineer.	1	Job		
11	Providing and installation of Door for store room size (3'x5') using 18gauge steel sheet using angle iron (3'x3'x 1/4") for frame as directed by Engineer.	1	Job		
12	Providing and installation of Water and feeding tube size(3'x5') using 18gauge steel sheet , using angle iron (3'x3'x 1/4") for frame and foots with cross angle supports as directed by Engineer.	0	Job		
13	Providing and installation of Sign Board size(3'x2.5') using 18gauge steel sheet , ILL-M pipe 1.5" dia as in frame & foots with cross angel iron double strips of 1 feet length, writing of given data double side with IR logo) as directed by Engineer.	1	Job		
GRAND TOTAL(Inclusive of Taxes, Transportaton, Deliveries & Installation)					

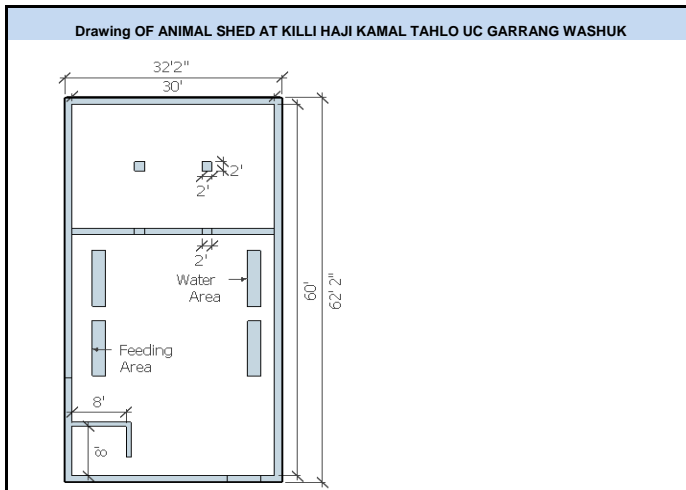



CONSTRUCTION OF ANIMAL SHED AT KILLI MIR ASGHAR TOLOKI UC GARRANG WASHUK

ESTIMATE OF ANIMAL SHED

Sr #	Description	Quantity	Unit	Unit Rate	Total Amount
1	Excavation in foundation of buildings and bridges including layout, dressing, refilling around structures with excavated earth, watering & ramming lead upto 100 ft. (30m) & lift upto 5 ft. (1.5m)	912	Cft		
2	Unburnt Brick Providing and laying sundried clay bricks set in mud mortar including scaffolding in fonudation and substructure.	2865.75	Cft		
3	Providing and filling earth over roof including watering, ramming, mud plastering with gobri leaping 3 inches (75mm) thick earth filling and mud plastering 1 inch (25mm) nominal thickness.	1444	Sft		
4	Mud Plaster	3936	Sft		
5	Girder	108	Rft		
6	Bamboo (20 ft. (6 m.) long and 3.5" to 4" (87.5 mm to 100 mm) dia.	930.0	Rft		
7	Mat (Thakird)	1444	Sft		
8	Mat (Partial)	1444	Sft		
9	Roof Plastic (Double Play)	1444	Sft		
10	Providing and installation of Iron Gate size(4'x 5') for animal shed using angle iron (3"x3"x 1/4") for frame , ILL-M pipe 1/2" dia use for center portion) as directed by Engineer.	1	Job		
11	Providing and installation of Door for store room size (3'x5') using 18gauge steel sheet using angle iron (3"x3"x 1/4") for frame as directed by Engineer.	1	Job		
12	Providing and installation of Water and feeding tube size(3'x5') using 18gauge steel sheet , using angle iron (3"x3"x 1/4") for frame and foots with cross angle supports as directed by Engineer.	4	Job		
13	Providing and installation of Sign Board size(3'x2.5') using 18gauge steel sheet , ILL-M pipe 1.5" dia as in frame & foots with cross angel iron double strips of 1 feet length, writing of given data double side with IR logo) as directed by Engineer.	1	Job		
GRAND TOTAL(Inclusive of Taxes, Transportation, Deliveries & Installation)					

Drawing OF ANIMAL SHED AT KILLI MIR ASGHAR TOLOKI UC GARRANG WASHUK

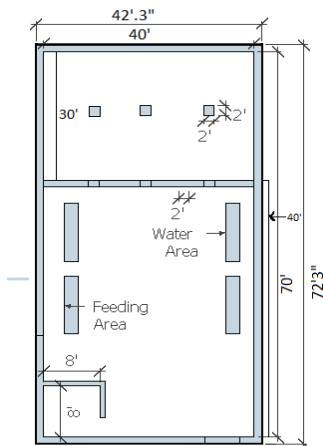

CONSTRUCTION OF ANIMAL SHED AT KILLI SOORGIL UC JANGIAN WASHUK					
ESTIMATE OF ANIMAL SHED					
Sr #	Description	Quantity	Unit	Unit Rate	Total Amount
1	Excavation in foundation of buildings and bridges including layout, dressing, refilling around structures with excavated earth, watering & ramming lead upto 100 ft. (30m) & lift upto 5 ft. (1.5m)	752	Cft		
2	Unburnt Brick Providing and laying sundried clay bricks set in mud mortar including scaffolding in fonudation and substructure.	2328.25	Cft		
3	Providing and filling earth over roof including watering, ramming, mud plastering with gobri leaping 3 inches (75mm) thick earth filling and mud plastering 1 inch (25mm) nominal thickness.	804	Sft		
4	Mud Plaster	3076	Sft		
5	Girder	46	Rft		
6	Bamboo (20 ft. (6 m.) long and 3.5" to 4" (87.5 mm to 100 mm) dia.	610.0	Rft		
7	Mat (Thakird)	804	Sft		
8	Mat (Partial)	804	Sft		
9	Roof Plastic (Double Play)	804	Sft		
10	Providing and installation of Iron Gate size(4'x5') for animal shed using angle iron (3"x3"x 1/4") for frame , ILL-M pipe 1/2" dia use for center portion) as directed by Engineer.	1	Job		
11	Providing and installation of Door for store room size (3'x5') using 18gauge steel sheet using angle iron (3"x3"x 1/4") for frame as directed by Engineer.	1	Job		
12	Providing and installation of Water and feeding tube size(3'x5') using 18gauge steel sheet , using angle iron (3"x3"x 1/4") for frame and foots with cross angle supports as directed by Engineer.	0	Job		
13	Providing and installation of Sign Board size(3'x2.5') using 18gauge steel sheet , ILL-M pipe 1.5" dia as in frame & foots with cross angel iron double strips of 1 feet length, writing of given data double side with IR logo) as directed by Engineer.	1	Job		
GRAND TOTAL(Inclusive of Taxes, Transportation, Deliveries & Installation)					

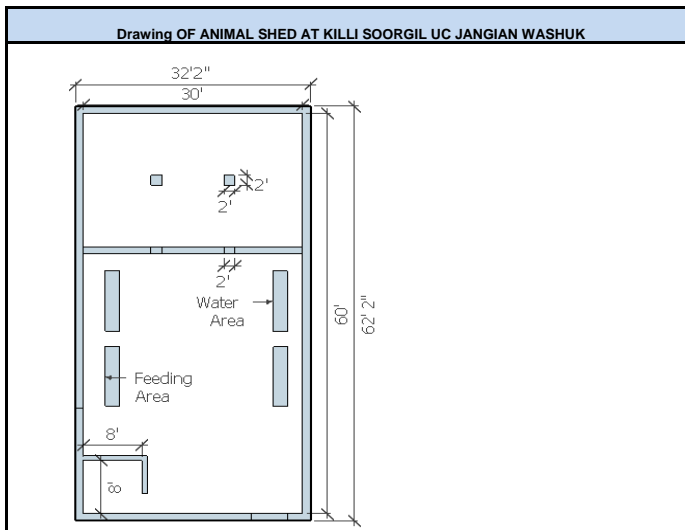

CONSTRUCTION OF ANIMAL SHED AT KILLI TAKHYA FAQEERZAI UC TOMULK KHARAN					
ESTIMATE OF ANIMAL SHED					
Sr #	Description	Quantity	Unit	Unit Rate	Total Amount
1	Excavation in foundation of buildings and bridges including layout, dressing, refilling around structures with excavated earth, watering & ramming lead upto 100 ft. (30m) & lift upto 5 ft. (1.5m)	752	Cft		
2	Unburnt Brick Providing and laying sundried clay bricks set in mud mortar including scaffolding in fonudation and substructure.	2328.25	Cft		
3	Providing and filling earth over roof including watering, ramming, mud plastering with gobi leaping 3 inches (75mm) thick earth filling and mud plastering 1 inch (25mm) nominal thickness.	804	Sft		
4	Mud Plaster	3076	Sft		
5	Girder	46	Rft		
6	Bamboo (20 ft. (6 m.) long and 3.5" to 4" (87.5 mm to 100 mm) dia.	610.0	Rft		
7	Mat (Thakird)	804	Sft		
8	Mat (Partial)	804	Sft		
9	Roof Plastic (Double Play)	804	Sft		
10	Providing and installation of Iron Gate size(4'x 5') for animal shed using angle iron (3"x3"x 1/4") for frame , ILL-M pipe 1/2" dia use for center portion) as directed by Engineer.	1	Job		
11	Providing and installation of Door for store room size (3'x5') using 18gauge steel sheet using angle iron (3"x3"x 1/4") for frame as directed by Engineer.	1	Job		
12	Providing and installation of Water and feeding tube size(3'x5') using 18gauge steel sheet , using angle iron (3"x3"x 1/4") for frame and foots with cross angle supports as directed by Engineer.	0	Job		
13	Providing and installation of Sign Board size(3'x2.5') using 18gauge steel sheet , ILL-M pipe 1.5" dia as in frame & foots with cross angel iron double strips of 1 feet length, writing of given data double side with IR logo) as directed by Engineer.	1	Job		
GRAND TOTAL(Inclusive of Taxes, Transportaton, Deliveries & Installation)					

